



Bobcat

One Tough Animal

POWERED STACKERS

Warehouse equipment, 1.2 to 1.6-ton capacity

🌐 EMEA

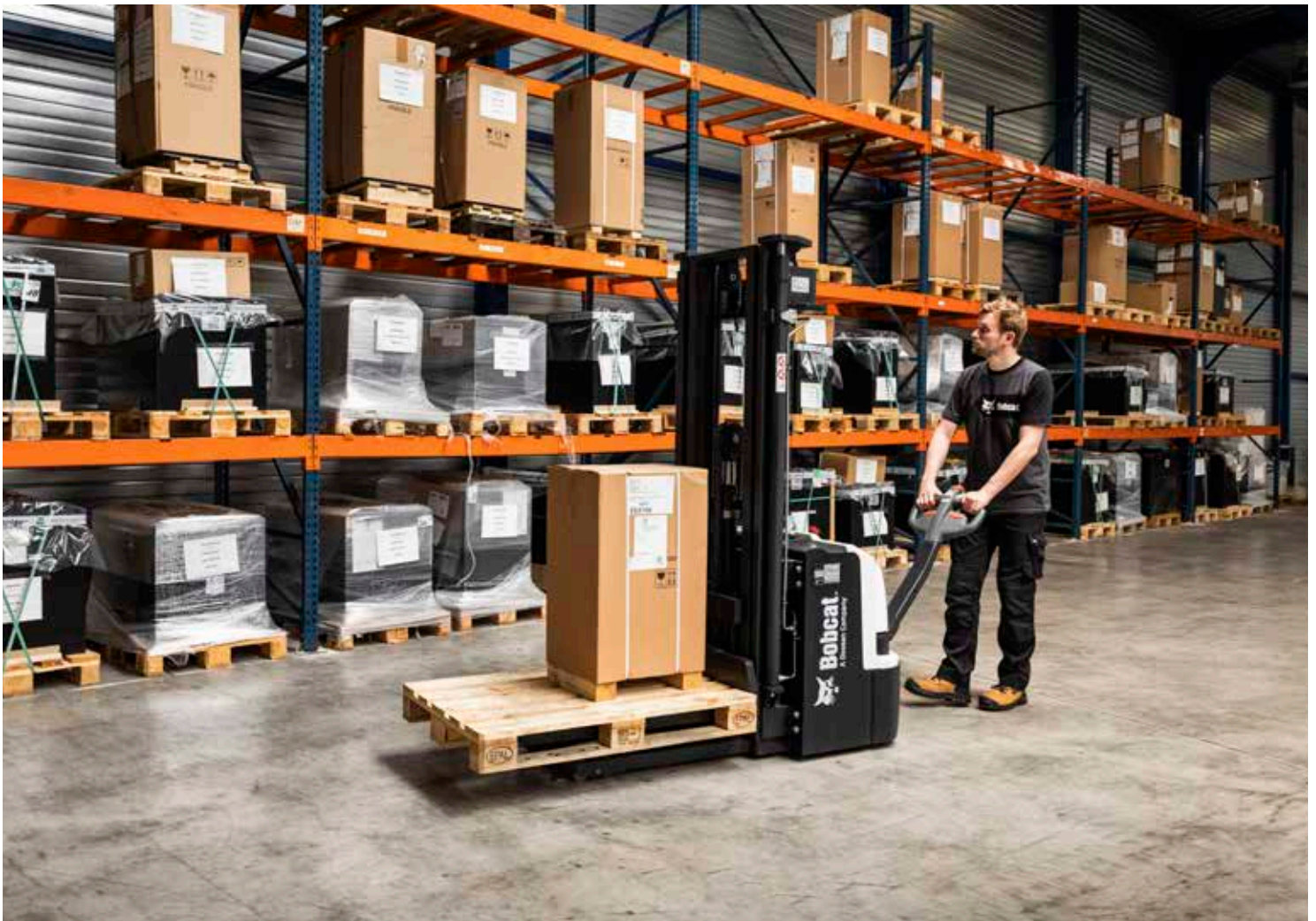

DEPENDABLE PERFORMANCE FOR EVERY TASK: THE BSL12/16N-7(i) STACKERS

The BSL12/16N-7(i) stackers, with a 1.2 to 1.6-ton capacity, are perfect for everyday warehouse tasks. With the optional initial lift, you can easily move over thresholds, bumps, and uneven floors, while the lateral drive ensures excellent traction and stability, even on ramps and slopes. Add a lithium-ion battery, and you'll have reliable, low-maintenance power with flexible charging options. Simple, durable, and designed to last, the BSL12/16N-7(i) stackers are a value-driven choice to keep your operations running smoothly.

At Bobcat, we understand the importance of having the right products and services. For more information, contact your local dealer or visit: www.bobcat.com.



TOUGH, AGILE & SAFE

THE PERFECT FIT FOR YOUR BUSINESS

Boost your productivity with Bobcat's stackers. The lateral drive system provides stability and excellent traction, while the ergonomic tiller head and lithium-ion battery ensure easy operation and maintenance. Built to deliver years of smooth performance, these stackers offer the efficiency your business deserves!

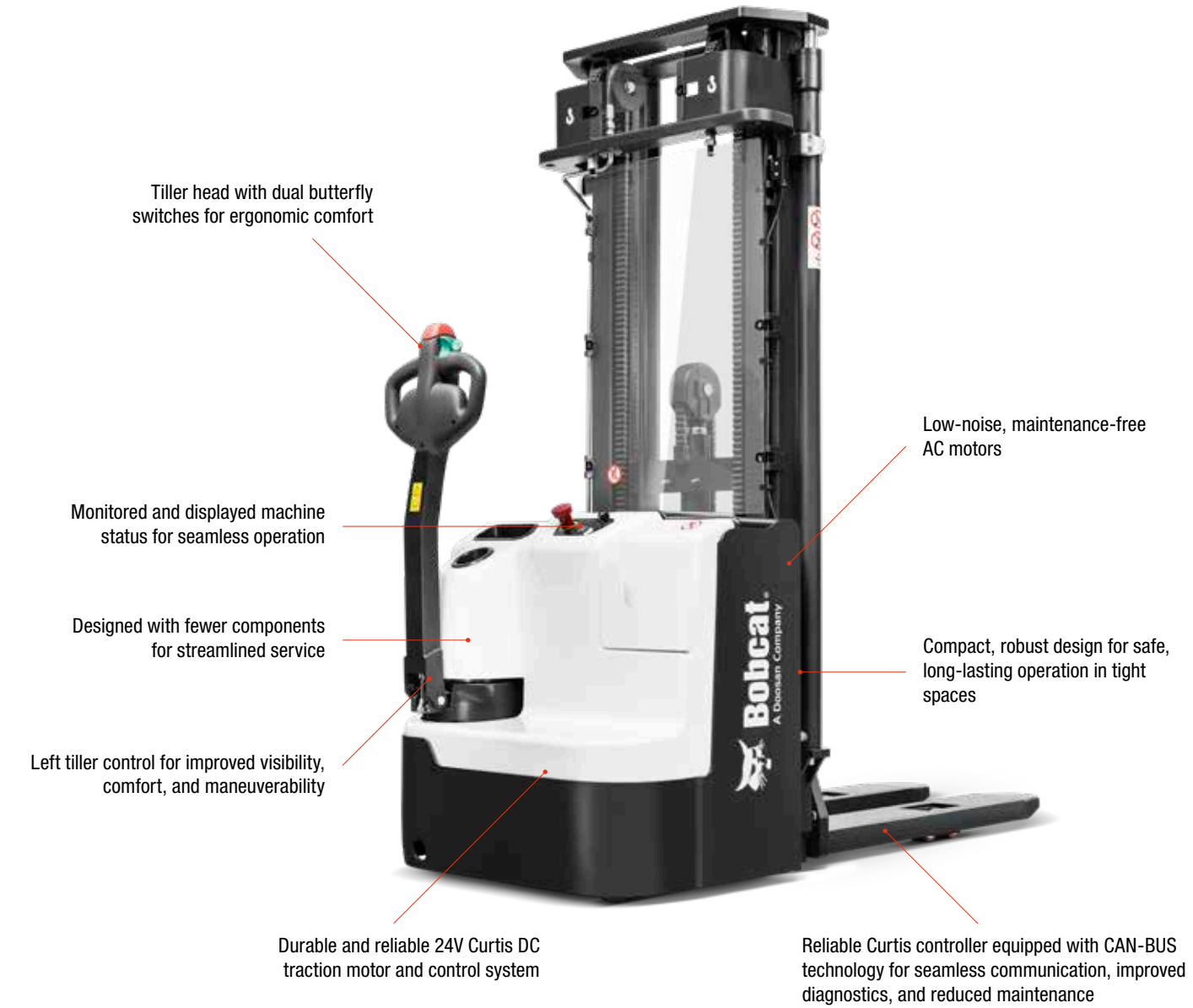

ACHIEVE MORE WITH LESS

With high stability, maneuverability, and smooth proportional lifting & lowering, our stackers help you stay productive all day long. Great performance at a fantastic value!



ALL-DAY COMFORT

Our stackers' ergonomic tiller head, high-quality display monitor, and initial lift provide a smooth, stable, and stress-free workday.



SECURE OPERATION

Feel at ease during shifts with excellent mast visibility, a safety reverse button, and more.



EVERYDAY PERFORMANCE

Robust design, superior component protection, and lithium-ion power come together to give you a truck that works as hard as you do.

EASE OF USE



► **ERGONOMIC TILLER CONTROL**

The ergonomic tiller arm is ideal for both left- and right-handed operators, with dual butterfly switches for smooth control. The extended tiller arm also provides safer, more comfortable handling throughout your shift.



► **SIMPLIFIED CONTROL AND INITIAL LIFT**

Our models easily navigate any space or warehouse layout, tackling thresholds, bumps, and uneven floors. The initial lift raises the forks up to 120 mm, offering improved stability and control on gradients.



► **ELECTRONIC PROPORTIONAL LIFTING AND LOWERING**

The proportional lift control on our stackers gives you precise lifting and lowering, reducing the risk of damage and accidents. Whether you're handling delicate or heavy loads, you have better control, smoother operation, and safer, more efficient lifting.



► **MONITORING DISPLAY**

Monitor your truck's status in real time to keep your operations running smoothly without interruptions.



► **MAST VISIBILITY**

With the wide-visibility mast, you'll have a clear view of both the forks and your surroundings, helping you stay safe and in control. Plus, you can choose from different mast heights to fit your needs.



► **AUTOMATIC ELECTROMAGNETIC PARKING BRAKE**

With the automatic electromagnetic parking brake, your truck stays locked in place the moment you release the tiller head. No slipping, no sliding – just safety and stability during breaks or between tasks



MAIN SPECIFICATIONS

TECHNICAL DATA ACCORDING TO VDI 2198						
		Unit	BSL12N-7	BSL12N-7i	BSL16N-7	BSL16N-7i
CHARACTERISTICS						
Drive			electric			
Operator type			walkie			
Load capacity / rated load center	Q	kg	1 200		1 600	
Load center	c	mm	600			
Load distance	x	mm	647	695	647	695
Wheelbase	y	mm	1 248	1 374	1 293	1 417
TIRES						
Tires			polyurethane (PU)			
Tire size, front		mm	230 × 70			
Tire size, rear		mm	85 × 75	84 × 70	85 × 75	84 × 70
Additional wheels (dimensions)		mm	150 × 54			
Track width, front	b10	mm	522			
Track width, rear	b11	mm	390 / 505			
DIMENSIONS						
Lift¹	h3	mm	2 830 – 4 530		2 830 – 5 430	
Initial lift	h5	mm	–	120	–	120
Height of tiller in drive position, min. / max.	h14	mm	850 / 1 385			
Height, lowered	h13	mm	90			
Overall length	l1	mm	1 919	1 998	1 964	2 042
Length to forkface	l2	mm	769	848	814	892
Overall width	b1	mm	820			
Fork dimensions	s/e/l	mm	60 / 180 / 1 150			
Distance over forks	b5	mm	570 / 685			
Ground clearance, center of wheelbase	m2	mm	28			
Aisle width for pallets 800 × 1 200 lengthways	Ast	mm	2 322	2 540	2 393	2 584
External turning radius	Wa	mm	1 440	1 667	1 510	1 711
PERFORMANCE DATA						
Travel speed, with / without load		km/h	6.0 / 6.0	5.5 / 6.0	5.7 / 6.0	5.5 / 6.0
Max. gradeability, with / without load		%	6 / 12			
Service brake			electromagnetic			
Energy consumption according to VDI cycle		kWh/h	0.95	1	1.59	0.96

Specification values in this sheet have been rounded. Performance may vary depending on operating conditions.
Products and specifications are subject to improvement and change without prior notice.
¹ Mast dimensions refer to a range from the lowest to the highest available mast.

STANDARD EQUIPMENT & OPTIONS

STANDARD EQUIPMENT & OPTIONS		
	BSL12N-7(i)	BSL16N-7(i)
PRODUCTIVITY		
Tandem load wheels	✓	✓
Display to monitor energy and machine status	✓	✓
Mechanical steering	✓	✓
Proportional lifting and lowering	✓	✓
Curtis controller	✓	✓
Initial lift	•	•
Lithium-ion battery and charger	•	•
Lead-acid battery²	•	•
FORKS		
1 150 / 570 mm	✓	✓
1 150 / 685 mm	✓	✓

• = option ✓ = standard – not available

*This list is based on factory data. Standard and optional features may vary by country.
² Only available in MEA & CIS

DIMENSIONS

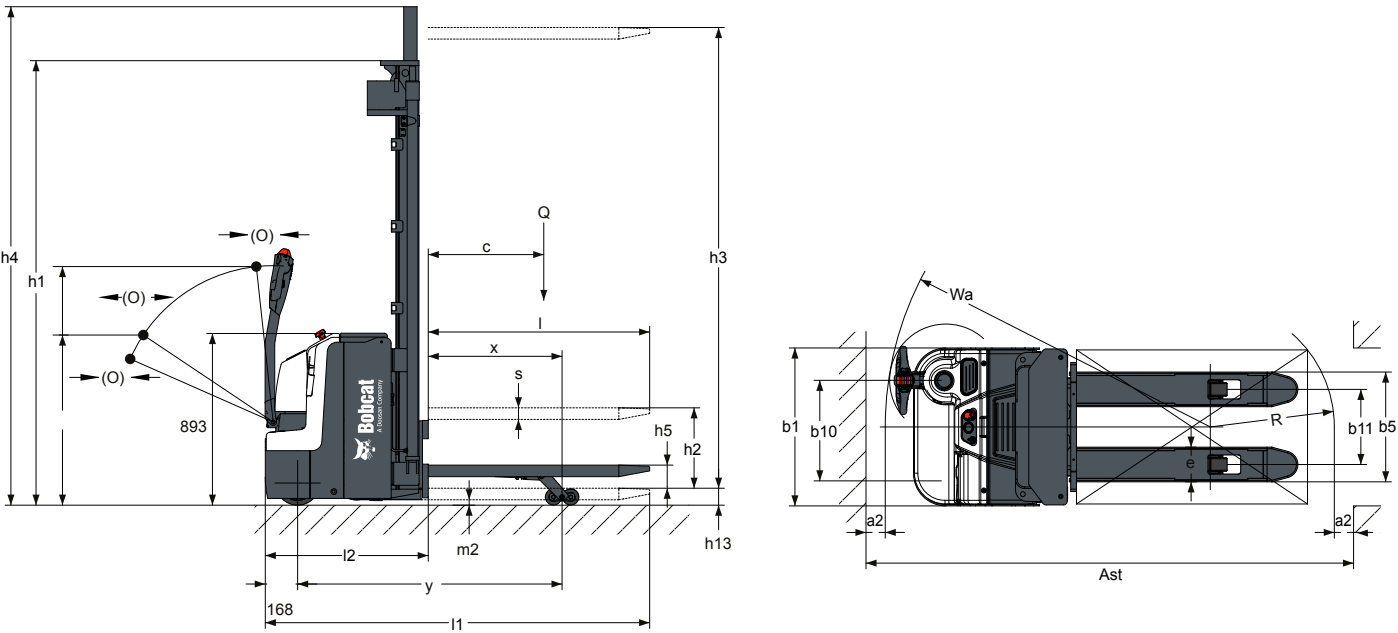

BUILT TO LAST

► EQUIPMENT YOU CAN COUNT ON

With its rugged design, 24V Curtis DC traction motor and control system, component protection, and simple battery maintenance, Bobcat warehouse equipment is engineered for great uptime and long-lasting performance.

1 YEAR

WARRANTY

► WARRANTY

Bobcat develops every machine to the highest standards of quality and durability. That's why our standard warranty provides 12 months or 2 000 operating hours (whichever occurs first) of parts coverage.

► BOBCAT GENUINE PARTS

Quality components delivered to our dealers guarantee that all of our equipment is built to last, withstand the toughest conditions, and deliver reliable performance.



► EXTENSIVE DEALER NETWORK

You can rely on our network of dealers and service partners who are always ready to help you.



Li-Ion
TECHNOLOGY



Europe



MEA



CIS

**SEE IF IT'S THE RIGHT FIT
FOR YOUR FLEET**



► LI-ION BATTERY WARRANTY

With a 60-month / 10 000 operating hours (whichever occurs first) warranty, Bobcat's lithium-ion battery ensures reliable performance and peace of mind for years.

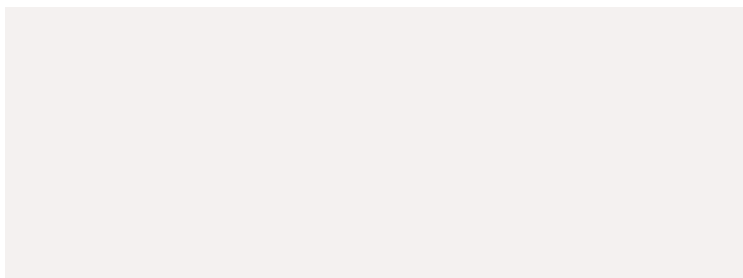

Doosan Bobcat EMEA, U Kodetky 1810, 263 12 Dobříš, Czech Republic

DOOSAN

Bobcat is a Doosan Company. Doosan is a global leader in construction equipment, power & water solutions, engines, and engineering proudly serving customers and communities for more than a century. | Bobcat and the Bobcat logo are registered trademarks of Bobcat Company in the United States and various other countries. ©2025 Bobcat Company. All Rights Reserved.

www.bobcat.com

©2025 BOBCAT L4503331-EN (05-25)